

Shift Lever Removal

1. Remove the ash tray, front console box, heater control panel (see page 20-91), driver's dashboard lower cover (see page 20-88), and dashboard gauge assembly cover (see page 20-87).
2. Disconnect the O/D switch/shift lock solenoid/park pin switch connector.
NOTE: The illustration shows LHD model; RHD is symmetrical.

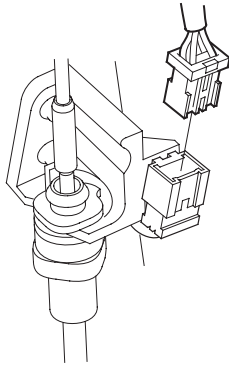

3. Shift the shift lever to [R] position.
4. Slide the lock tab (A) down on the shift cable end holder (B).

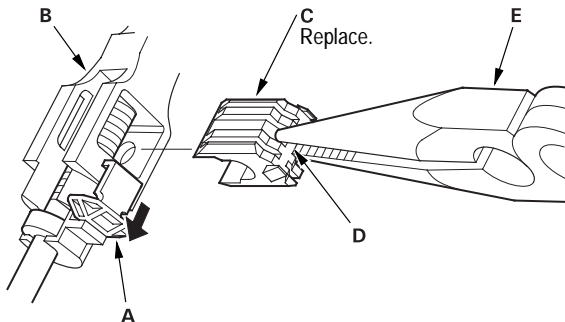

5. Remove the shift cable lock (C) with holding at the middle (D) of it using needle-nose pliers (E) from the shift cable end and shift cable end holder.
NOTE: Do not pry the shift cable lock with a screwdriver, it may damage the shift cable end holder.
6. Separate the shift cable end from the shift cable end holder.

7. Rotate the socket holder (A) on the shift cable (B) a quarter turn; the tab (C) on the socket holder will be in the opening (D) of the socket holder bracket (E). Then slide the holder to remove the shift cable from the socket holder bracket.

NOTE: Do not remove the shift cable by twisting the shift cable guide (F) and damper (G).

LHD Model:

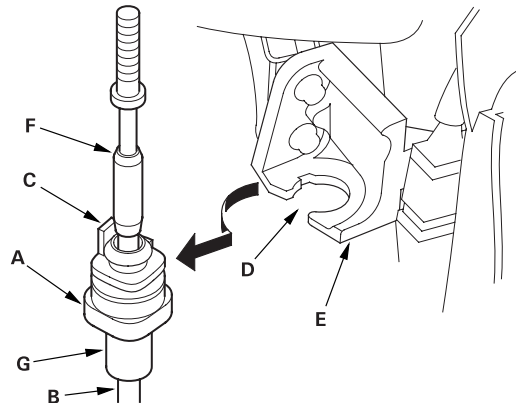

RHD Model:

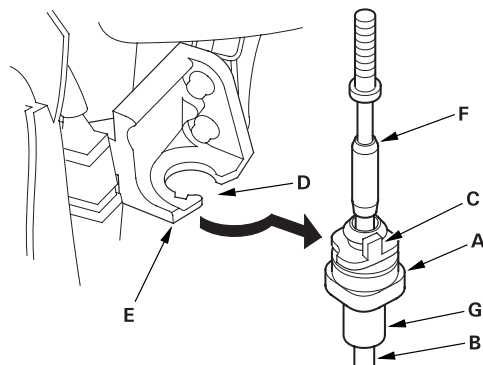



8. Remove the shift lever assembly.

NOTE: The illustration shows LHD model; RHD is symmetrical.

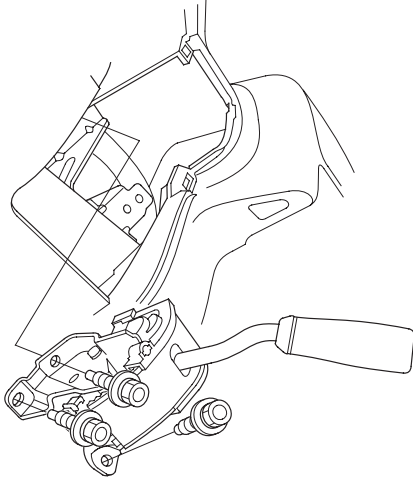

Shift Lever Installation

1. Install the shift lever assembly.

NOTE: The illustration shows LHD model; RHD is symmetrical.

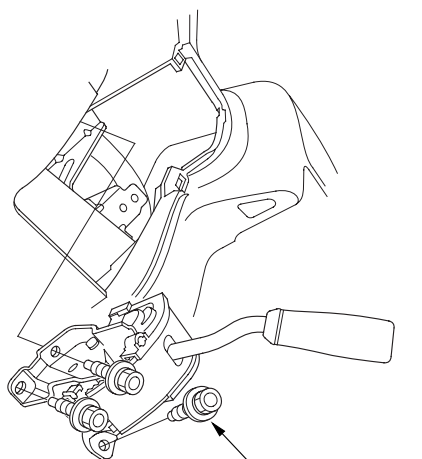

8 x 1.25 mm
22N·m
(2.2 kgf·m, 16 lbf·ft)

2. Turn the ignition switch ON (II), and verify that the [R] position indicator comes on.
3. If necessary, push the shift cable until it stops, then release it. Pull the shift cable back one step so that the shift cable is in [R]. Do not hold the shift cable guide (A) to adjust the shift cable (B).

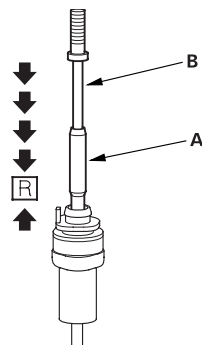

4. Turn the ignition switch OFF.
5. Insert a 6.0 mm (0.24 in.) pin (A) into the positioning hole (B) on the shift lever bracket base through the positioning hole (C) on the shift lever. The shift lever is secured in [R] position.

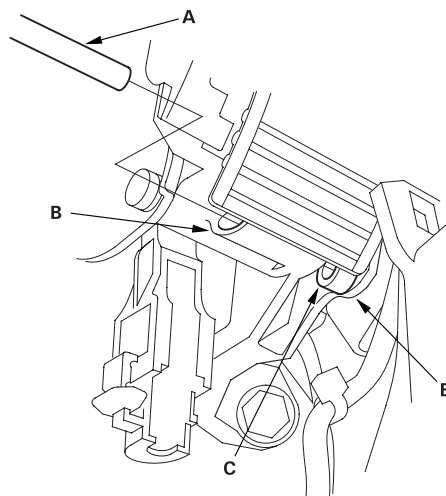



6. Rotate the socket holder (A) on the shift cable (B) to face the tab (C) on the holder opposite to the opening (D) in the socket holder bracket (E). Align the holder with the opening in the bracket, then slide the holder into the bracket. Rotate the holder a quarter turn to secure the shift cable. Do not install the shift cable by twisting the shift cable guide (F) and damper (G).

LHD Model:

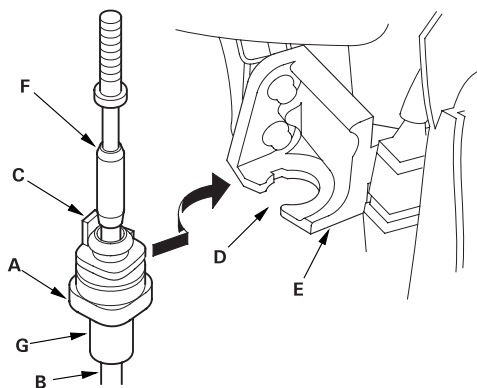

RHD Model:

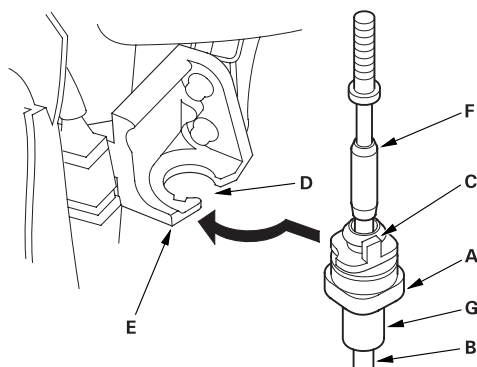

7. Install the shift cable end (A) in the shift cable end holder (B). Keep the shift cable end and end holder free of grease.

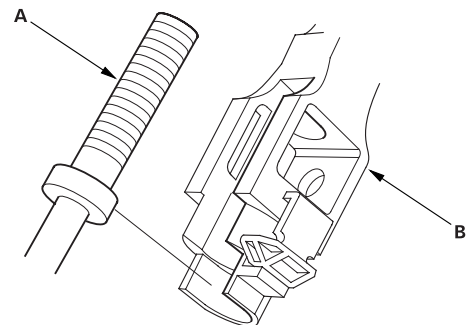

8. Install the new shift cable lock (A) to secure the shift cable end and shift cable end holder, then push the lock tab (B) up until it stops to lock the joint.

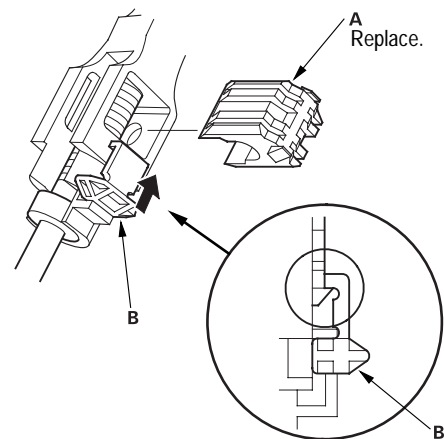

9. Remove the 6.0 mm (0.24 in.) pin that was installed to hold the shift lever.
10. Connect the O/D switch/shift lock solenoid/park pin switch connector.
11. Move the shift lever to each gear, and verify that the A/T gear position indicator follows the transmission range switch.
12. Install the dashboard gauge assembly cover ([see page 20-87](#)), driver's dashboard lower cover ([see page 20-88](#)), heater control panel ([see page 20-91](#)), front console box, and ash tray.

Shift Lever Disassembly/Reassembly

NOTE: The illustration shows the LHD model: RHD is symmetrical.

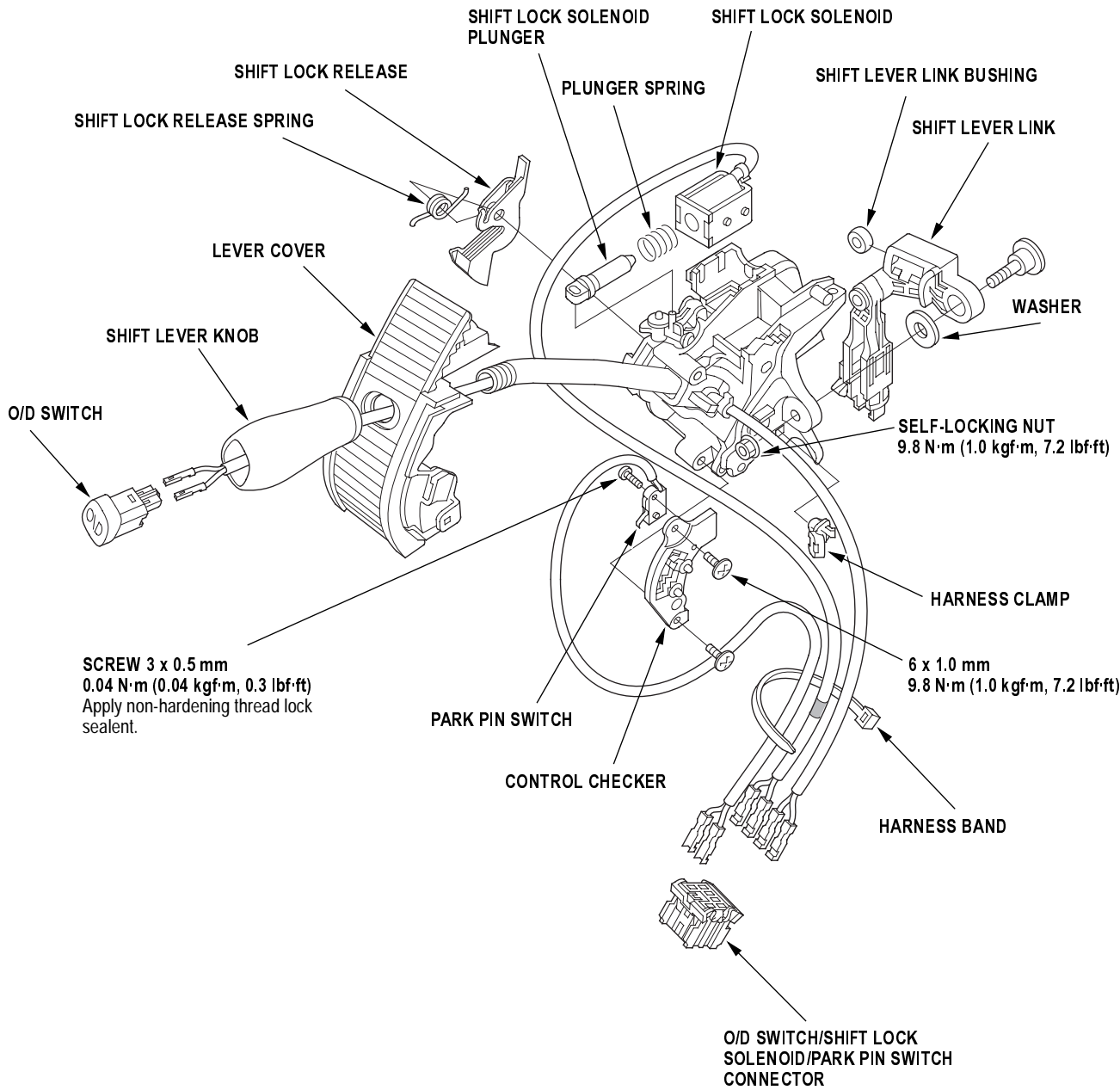



Shift Cable Replacement

1. Raise the front of the vehicle, and make sure it is securely supported, or lift the vehicle up.
2. Remove the ash tray, front console box, heater control panel (see page 20-91), driver's dashboard lower cover (see page 20-88), and dashboard gauge assembly cover (see page 20-87).
3. Shift the shift lever to [R] position.
4. Slide the lock tab (A) down on the shift cable end holder (B).

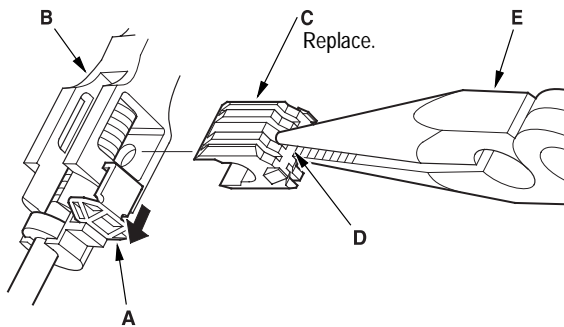

5. Remove the shift cable lock (C) with holding at the middle (D) of it using needle-nose pliers (E) from the shift cable end and shift cable end holder.
NOTE: Do not pry the shift cable lock with a screwdriver, it may damage the shift cable end holder.
6. Separate the shift cable end (A) from the shift cable holder (B).

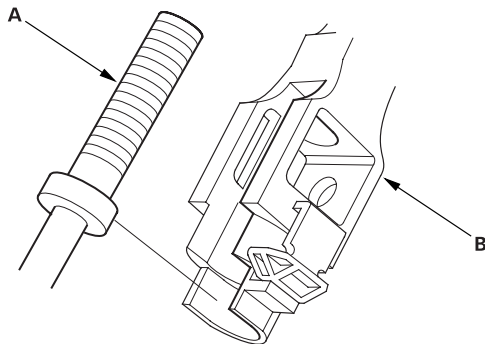

7. Rotate the socket holder (A) on the shift cable (B) a quarter turn; the tab (C) on the socket holder will be in the opening (D) of the socket holder bracket (E). Then slide the holder to remove the shift cable from the socket holder bracket.

LHD Model:

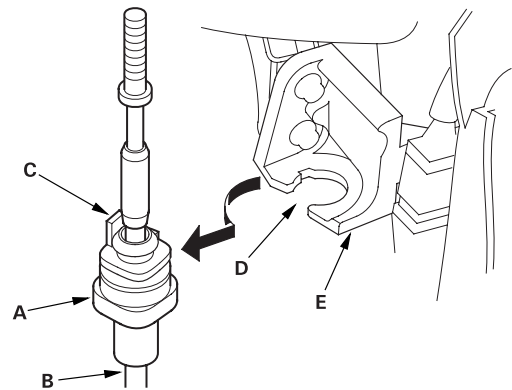

RHD Model:

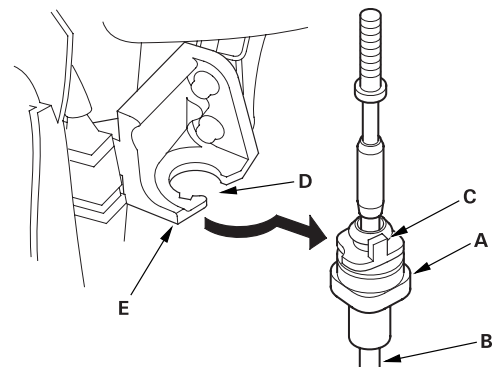

(cont'd)

Shift Cable Replacement (cont'd)

8. For RHD model; Remove the shift cable from the clamp.

NOTE: The LHD model doesn't have shift cable clamp.

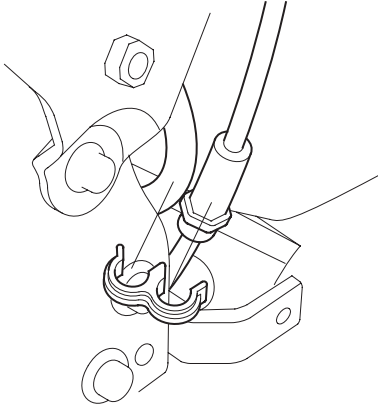

9. Remove the grommet under the body, and pull out the shift cable.

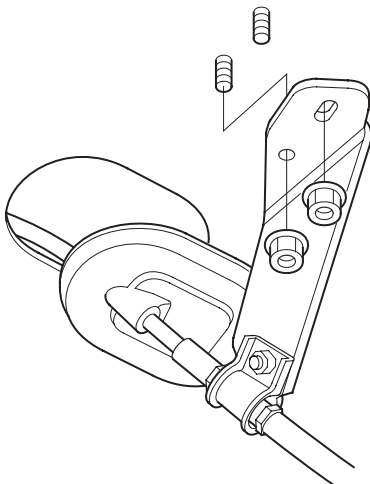

10. Replace the shift cable for 4WD model.

- 1 Remove the bolts (A) securing the shift cable bracket (B), then remove the shift cable cover (C).
- 2 Remove the spring clip (D) and control pin (E), then separate the shift cable (F) from the control lever (G).
- 3 Remove the bolts (H) securing the shift cable bracket (I), then remove the shift cable bracket (I) from the shift cable.
- 4 Replace the shift cable, and insert it through the grommet hole. Do not bend the shift cable excessively. Face the dot (J) on the shift cable (F) down, then install the shift cable bracket (I) on the shift cable.
- 5 Attach the shift cable end (K) to the control lever (G), then insert the control pin (E) into the control lever hole through the shift cable end. Secure the control pin with the spring clip (D).
- 6 Secure the shift cable bracket (B) with the bolts (A), and install the shift cable cover (C) with installing the mounting bolts loosey.
- 7 First tighten the front bolt (L) on the cover, then lower bolt (M), and lastly the middle bolt (N).

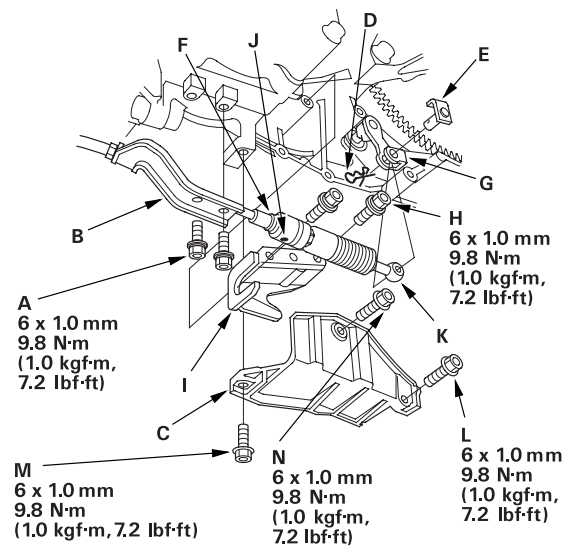



11. Replace the shift cable for 2WD model.

- 1 Remove the shift cable cover (A).
- 2 Remove the spring clip (B) and control pin (C), then separate the shift cable (D) from the control lever (E).
- 3 Remove the bolts securing the shift cable bracket (F).
- 4 Replace the shift cable, and insert it through the grommet hole. Do not bend the shift cable excessively.
- 5 Attach the shift cable end (D) to the control lever (E), then insert the control pin (C) into the control lever hole through the shift cable end, and secure the control pin with the spring clip (B).
- 6 Secure the shift cable bracket (F) with the bolt, and install the shift cable cover (A) with installing the mounting bolts loosey.
- 7 First tighten the front bolt (G) on the cover, then lower bolt (H), and lastly the middle bolt (I).

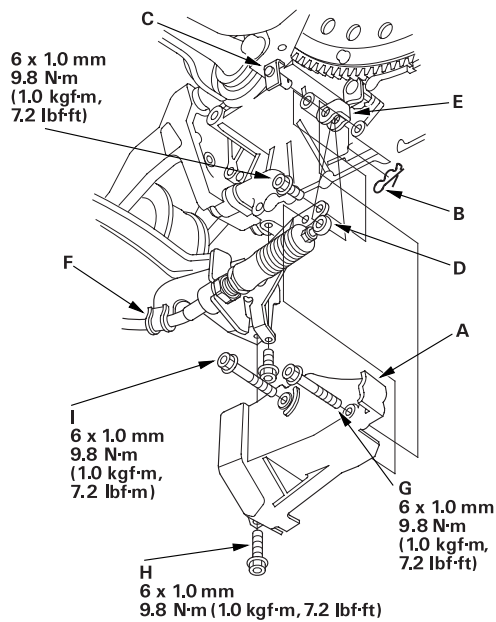

12. Install the shift cable bracket (A) on the body, then install the grommet (B) in its hole (C).

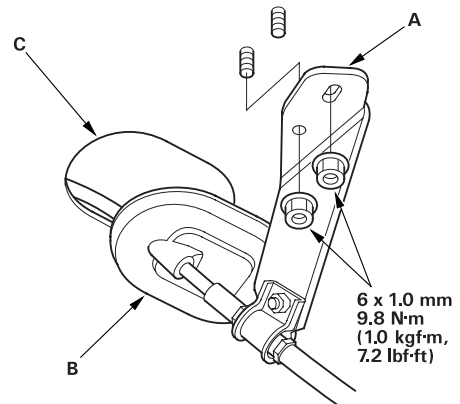

13. For RHD model; Install the shift cable (A) on its clamp (B) at the crimped ring (C).

NOTE: The LHD model doesn't have shift cable clamp.

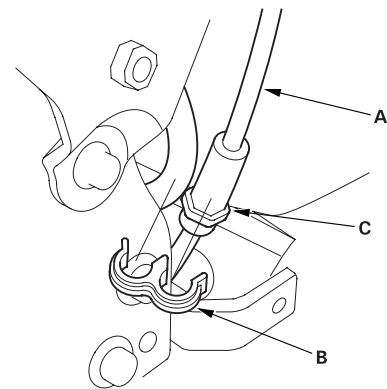

(cont'd)

Shift Cable Replacement (cont'd)

14. Turn the ignition switch ON (II), and verify that the [R] position indicator comes on.
15. If necessary, push the shift cable until it stops, then release it. Pull the shift cable back one step so that the shift cable is in [R]. Do not hold the shift cable guide (A) to adjust the shift cable (B).

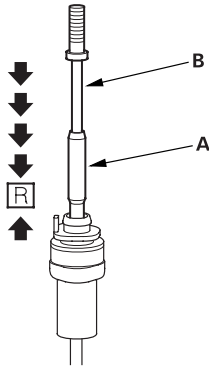

16. Turn the ignition switch OFF.
17. Insert a 6.0 mm (0.24 in.) pin (A) into the positioning holes (B) on the shift lever bracket base through the positioning hole (C) on the shift lever. The shift lever is secured in [R] position.

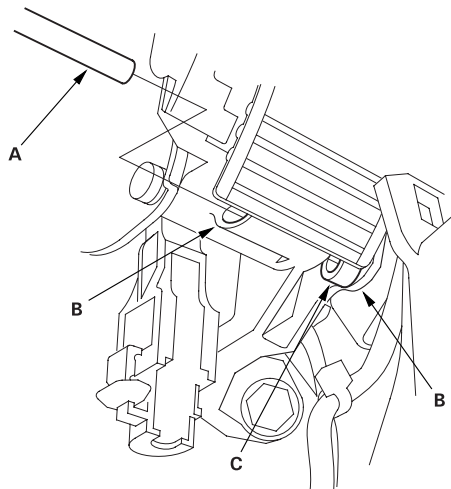

18. Rotate the socket holder (A) on the shift cable (B) to face the tab (C) on the holder opposite to the opening (D) in the socket holder bracket (E). Align the holder with the opening in the bracket, then slide the holder into the bracket. Rotate the holder a quarter turn to secure the shift cable. Do not install the shift cable by twisting the shift cable guide (F) and damper (G).

LHD Model:

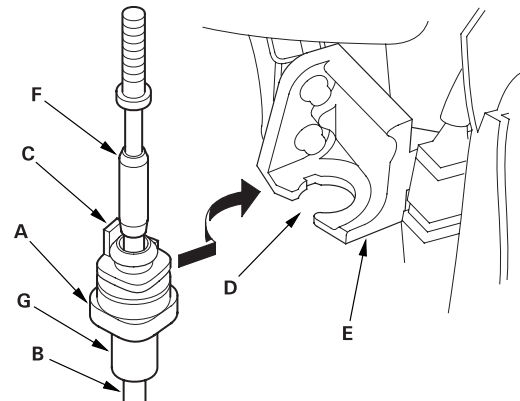

RHD Model:

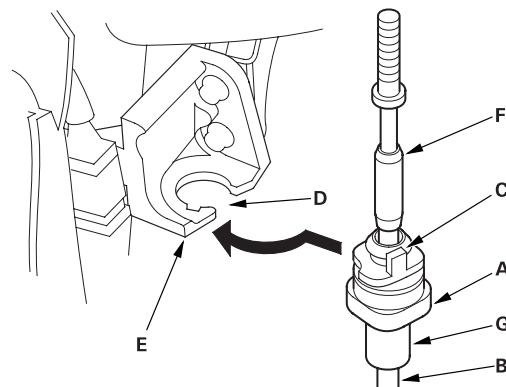



19. Install the shift cable end (A) in the shift cable end holder (B). Keep the shift cable end and end holder free of grease.

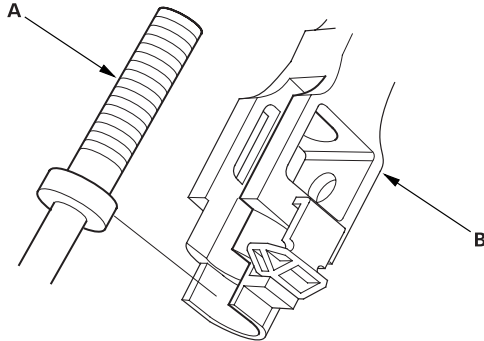

20. Install the new shift cable lock (A) to secure the shift cable end and shift cable end holder, then push the lock tab (B) up until it stops to lock the joint.

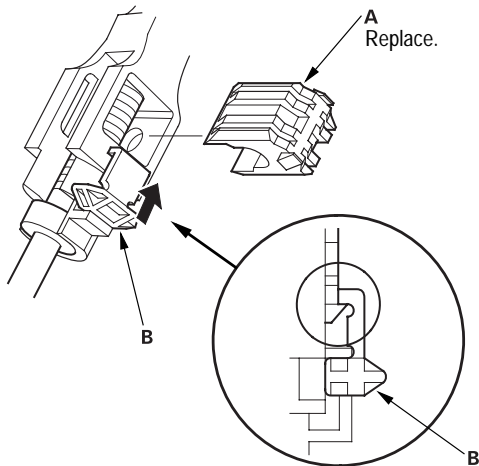

21. Remove the 6.0 mm (0.24 in.) pin that was installed to hold the shift lever.
22. Move the shift lever to each gear, and verify that the A/T gear position indicator follows the transmission range switch.
23. Allow the wheels to rotate freely.
24. Start the engine, and check the shift lever operation in all gears.
25. Install the dashboard gauge assembly cover ([see page 20-87](#)), driver's dashboard lower cover ([see page 20-88](#)), heater control panel ([see page 20-91](#)), front console box, and ash tray.

Shift Cable Adjustment

1. Remove the ash tray, front console box, heater control panel (see page 20-91), driver's dashboard lower cover (see page 20-88), and dashboard gauge assembly cover (see page 20-87).
2. Shift the shift lever to [R] position.
3. Slide the lock tab (A) down on the shift cable end holder (B).

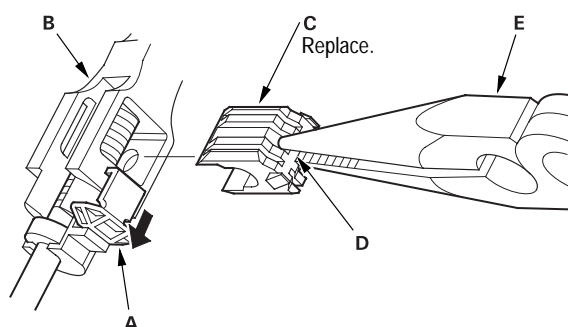

4. Remove the shift cable lock (C) with holding at the middle (D) of it using needle-nose pliers (E) from the shift cable end and shift cable end holder.

NOTE: Do not pry the shift cable lock with a screwdriver, it may damage the shift cable end holder.

5. Separate the shift cable end (A) from the shift cable end holder (B).

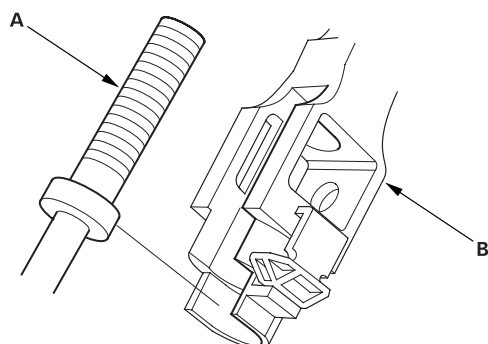

6. Rotate the socket holder (A) on the shift cable (B) a quarter turn; the tab (C) on the socket holder will be in the opening (D) of the socket holder bracket (E). Then slide the holder to remove the shift cable from the socket holder bracket.

NOTE: Do not remove the shift cable by twisting the shift cable guide (F) and damper (G).

LHD Model:

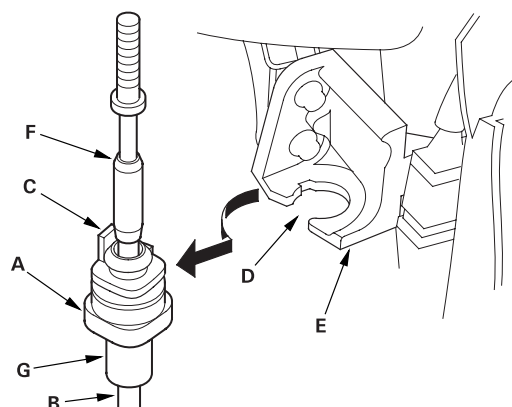

RHD Model:

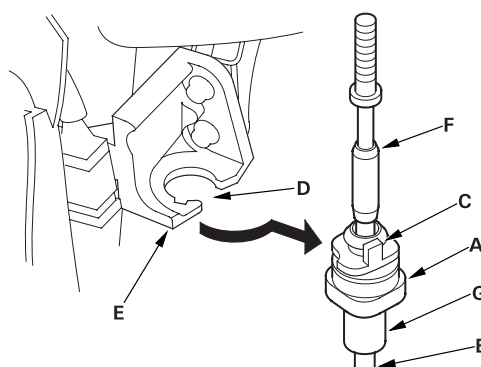



7. Push the shift cable down until it stops, then release it. Pull the shift cable back one step so that the shift cable is in [R]. Do not hold the shift cable guide (A) to adjust the shift cable (B).

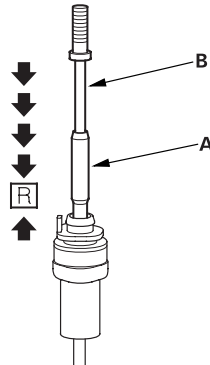

8. Turn the ignition switch ON (II), and verify that the [R] position indicator comes on.
9. Turn the ignition switch OFF.
10. Insert a 6.0 mm (0.24 in.) pin (A) into the positioning hole (B) on the shift lever bracket base through the positioning hole (C) on the shift lever. The shift lever is secured in [R] position.

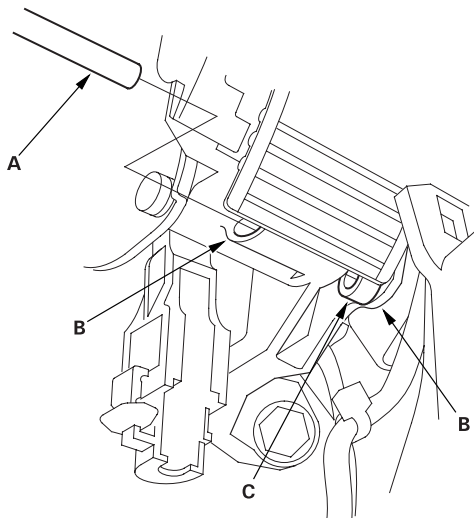

11. Rotate the socket holder (A) on the shift cable (B) to face the tab (C) on the holder opposite to the opening (D) in the socket holder bracket (E). Align the holder with the opening in the bracket, then slide the holder into the bracket. Rotate the holder a quarter turn to secure the shift cable. Do not install the shift cable by twisting the shift cable guide (F) and damper (G).

LHD Model:

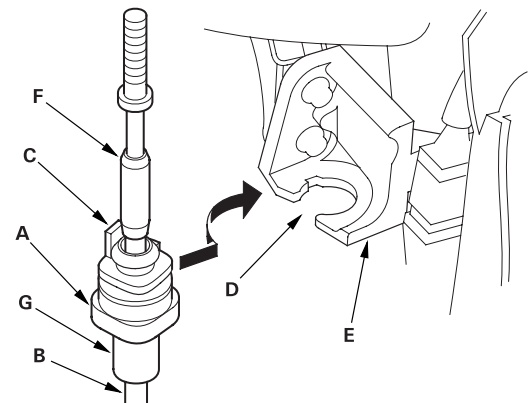

RHD Model:

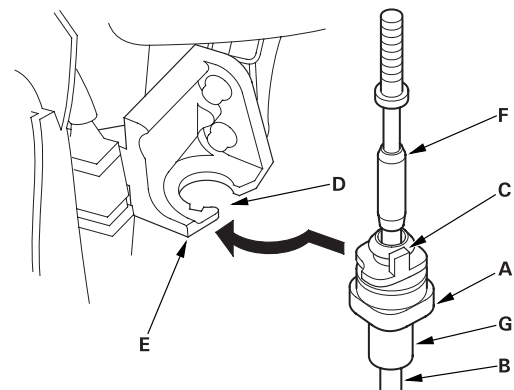

(cont'd)

Shift Cable Adjustment (cont'd)

12. Install the shift cable end (A) in the shift cable end holder (B). Keep the shift cable end and end holder free of grease.

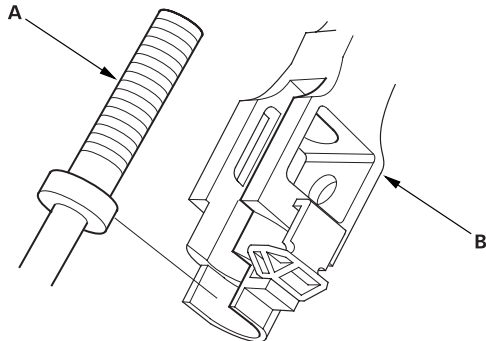

13. Install the new shift cable lock (A) to secure the shift cable end and shift cable end holder, then push the lock tab (B) up until it stops to lock the joint.

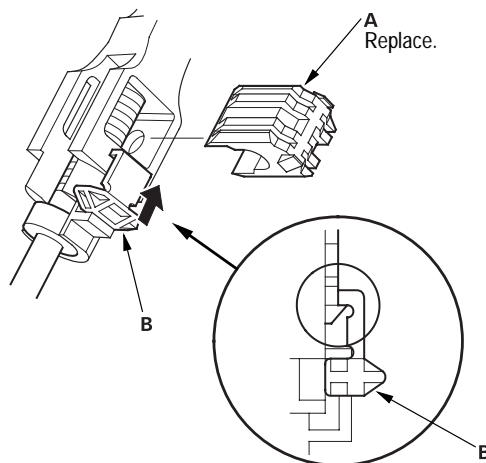

14. Remove the 6.0 mm (0.24 in.) pin that was installed to hold the shift lever.
15. Connect the O/D switch/shift lock solenoid/park pin switch connector.
16. Move the shift lever to each gear, and verify that the A/T gear position indicator follows the transmission range switch.
17. Allow the wheels to rotate freely.
18. Start the engine, and check the shift lever operation in all gears.
19. Turn the engine off. Push the shift lock release, and verify that the shift lever releases.
20. Install the dashboard gauge assembly cover ([see page 20-87](#)), driver's dashboard lower cover ([see page 20-88](#)), heater control panel ([see page 20-91](#)), front console box, and ash tray.