

## Speaker Replacement

### Door Speaker:

1. Remove the door panel (see page 20-9).
2. Push down on the clip, then pull the top of the speaker (A) straight out just enough to release the upper clip. If you pull the speaker out too far, you will damage the lower clips (C). Then lift the speaker straight up to release the lower clips.

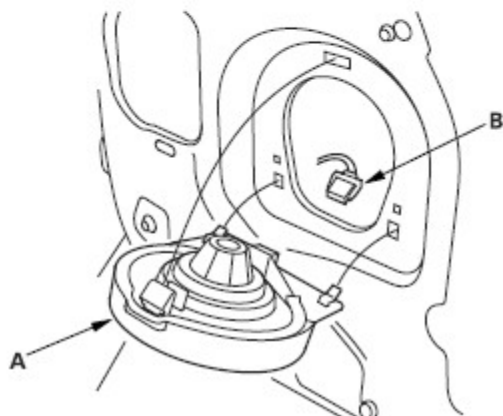

3. Disconnect the 2P connector (B), and remove the speaker.
4. Install the speaker in the reverse order of removal.

### Tweeter:

1. Remove the tweeter speaker grille (A) and tweeter (B) as an assembly.
2. Disconnect the 2P connector (C) from the tweeter.
3. Remove the tweeter speaker grille from the tweeter.

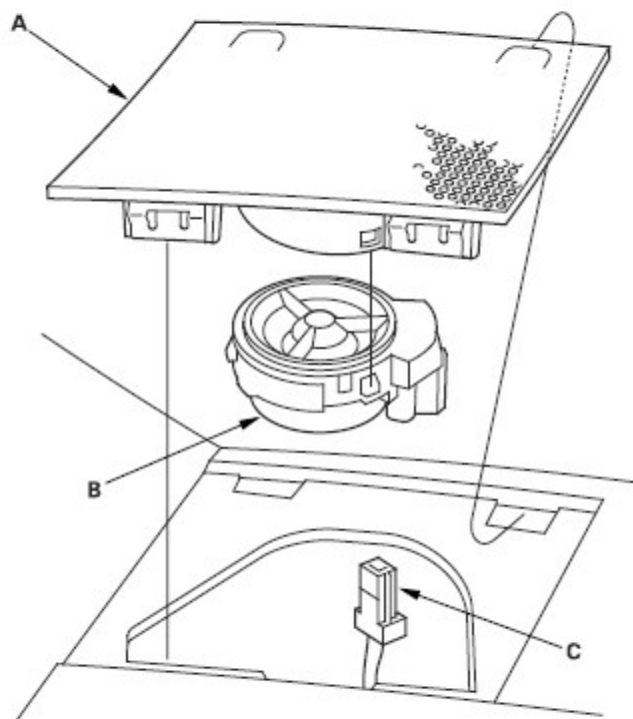

4. Install the tweeter in the reverse order of removal.